

Attachment A

A1 – Environmental Protection Agency Heritage Register Boundary Map (File No 602235) – Student Residences, QUT Kelvin Grove Campus

A2 – Environmental Protection Agency Heritage Register Boundary Map (File No 601966) - Former Gona Barracks, Kelvin Grove Road, Kelvin Grove

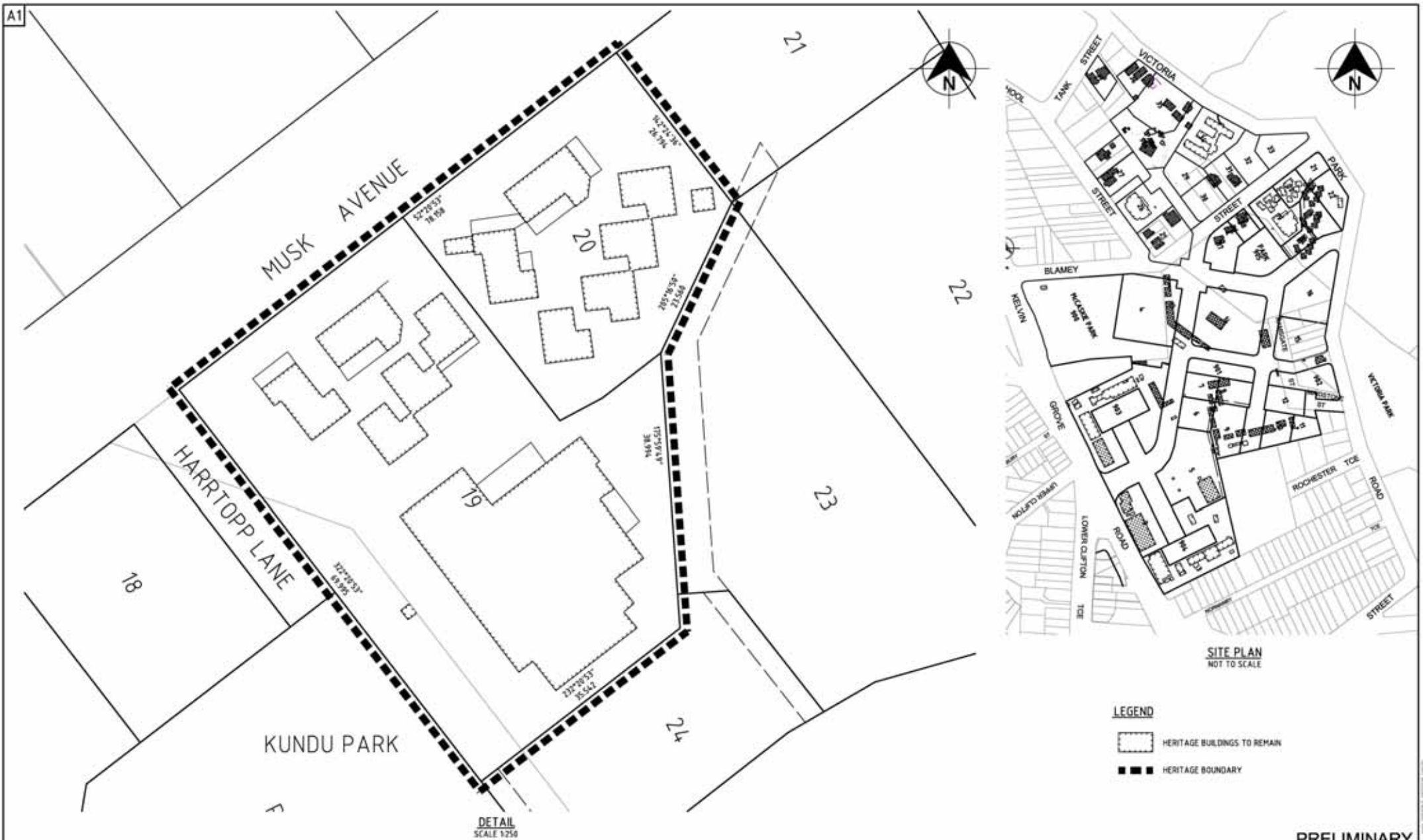

SITE PLAN
NOT TO SCALE

- LEGEND**
- HERITAGE BUILDINGS TO REMAIN
 - HERITAGE BOUNDARY

Rev	Date	Revision Details	By	Ver	App
01	04/09/01	PRELIMINARY ISSUE	JM		
02	21/01/03	LOT BOUNDARIES ADDED	BAL		
03	28/01/03	DEMOLISHED BUILDINGS DELETED	BAL		
04	04/02/03	LOT RENAMING	BAL		

Client:

Queensland Government
Department of Housing

Project Manager:

Project Services
Queensland Government
Department of Public Works

Principal Consultant:

Connell Wagner

Connell Wagner Pty Ltd
153 Boundary St, Carmel Reg, QLD Spring Hill
Queensland 4001, Australia

Sub-Consultants:

PRELIMINARY

kelvin grove urban village.

Drawn	Original signed by	Date	Drawing Title	City Project No.
BAL			STUDENT ACCOMODATION EXISTING STRUCTURES HERITAGE BOUNDARIES	0654
Designed				
MOR				
Verified				
Approved			Scale	1:250@ A1
Recommended			Drawing No.	0654SK186
			BCC REF:DRS/USE/H01-799577	Rev.
				04

- LEGEND**
- HERITAGE LISTED BUILDINGS CLASHING WITH PROPOSED MASTERPLAN BUILDINGS
 - BUILDINGS TO BE DEMOLISHED
 - CANCELLED BOUNDARIES

- NOTES**
- HORIZONTAL DATUM - MGA (2011)
 - LEVEL DATUM - AHD
 - CONTOUR INTERVAL - 1m
 - ORIGIN OF LEVELS - PM 1:25 (RL - 68.16 AND)

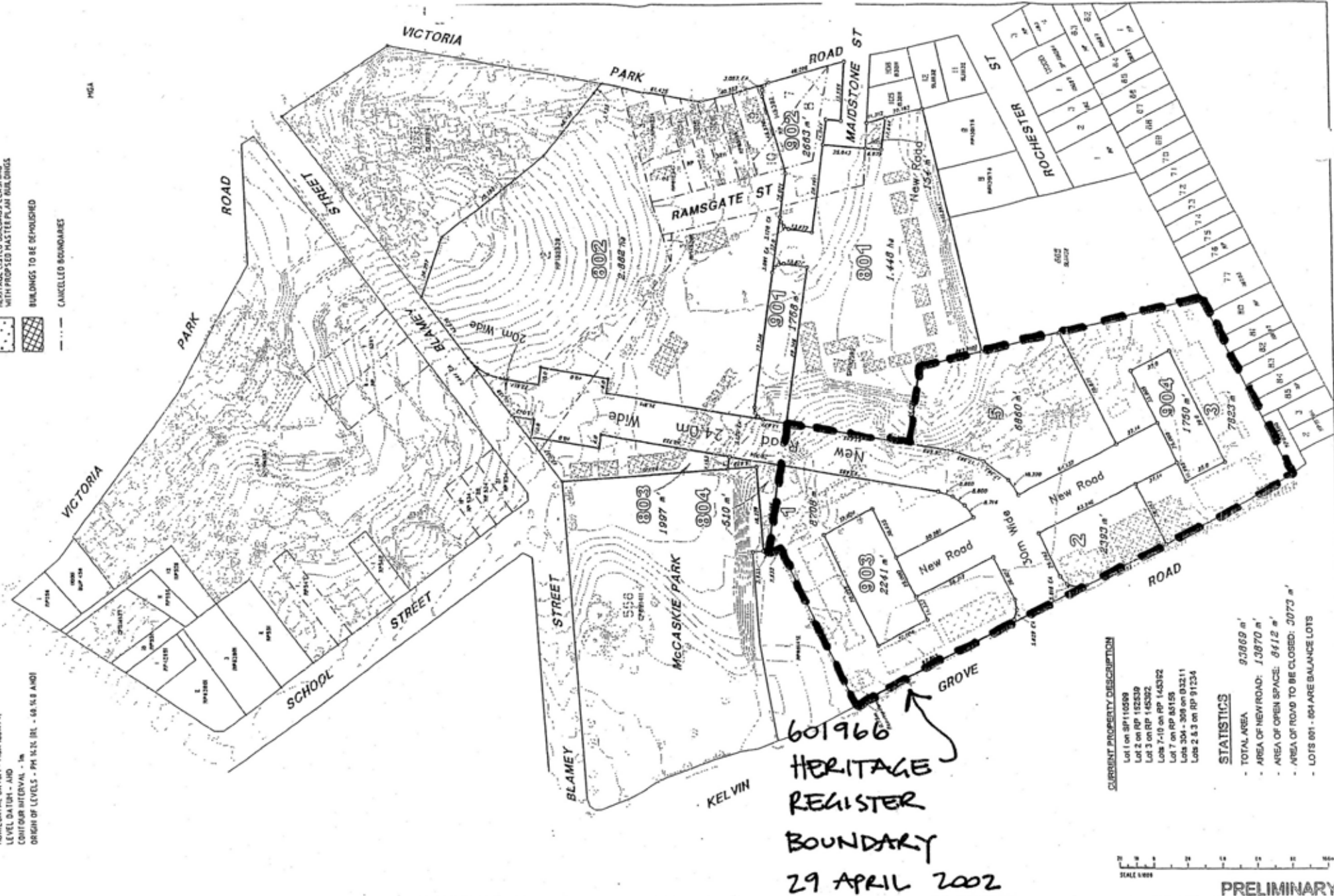

CURRENT PROPERTY DESCRIPTION

- Lot 1 on RP 110599
- Lot 2 on RP 152539
- Lot 3 on RP 145352
- Lots 7-10 on RP 145352
- Lot 7 on RP 85155
- Lots 304-308 on 03211
- Lots 2.5.3 on RP 91234

STATISTICS

- TOTAL AREA 93869 m²
- AREA OF NEW ROAD: 13870 m²
- AREA OF OPEN SPACE: 6412 m²
- AREA OF ROAD TO BE CLOSED: 3073 m²
- LOTS 801 - 804 ARE BALANCE LOTS

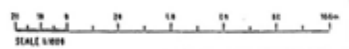

PRELIMINARY

Rev.	Date	Revision Details	By	Ver.	App.

Connell Wagner 0654 5K817
 Connell Wagner Pty Ltd ABN 54 055 128 873 Mooloolah QLD 467 2218 8225
 123 Boundary St, Southport QLD 4215 Southport QLD 4215 2218 8225
 Queensland 4215 Australia Email: info@connellwagner.com

Client: **Project Services** Queensland Government Department of Public Works

Architect:

Project: **KELVIN GROVE URBAN VILLAGE**

Drawn	Checked	Date	Drawing Title

STAGE 1A
 LOT RECONFIGURATION
 PLAN OF LOTS 1,2,3 & 5, 901-904
 & 801-804

CV Project No.	0654
Scale	1:1000
Drawing No.	0654SK017
Rev.	01